

Downtown Campus

Directory

St. Clair College Centre for the Arts

Fourth Floor

| | |
|-------------------|---------|
| Balcony | 332 |
| Presentation Room | 429 |
| Roof Terrace | 401 |
| Faculty Offices | 435-445 |

Third Floor

| | |
|------------------|---------|
| Balcony | 332 |
| Theatre Lounge | 322 |
| Catering Offices | 342-358 |

Second Floor

| | |
|---------------------|-----|
| Stage | 255 |
| Chrysler Theatre | 233 |
| Theatre Lobby | 218 |
| Skyline Alumni Room | 201 |
| Kitchen | 208 |
| Green Room | 253 |

First Floor

| | |
|------------------|---------|
| Dieppe Room | 101-102 |
| Theatre Foyer | 132 |
| Box Office | 141 |
| Student Services | SC |

Basement Level

| | |
|--------------------|------------|
| Executive Theatre | B013 |
| Health Clinic | B014 |
| PC Lab | B001, B011 |
| MAC Lab | B005-B006 |
| Tutoring Services | B009 |
| Photography Lab | B010 |
| Testing Lab | B002 |
| Open Lab | B004 |
| Guidance Counselor | B015 |
| One Card | B017 |
| Quiet Room | B136 |

Third Floor

Centre for the Arts Building

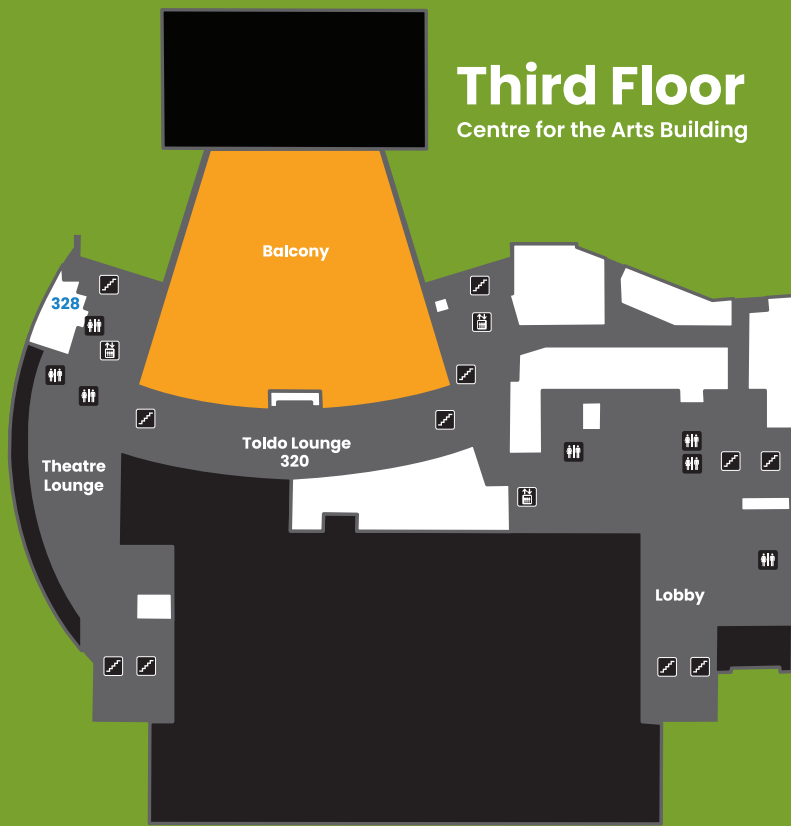

Fourth Floor

Centre for the Arts Building

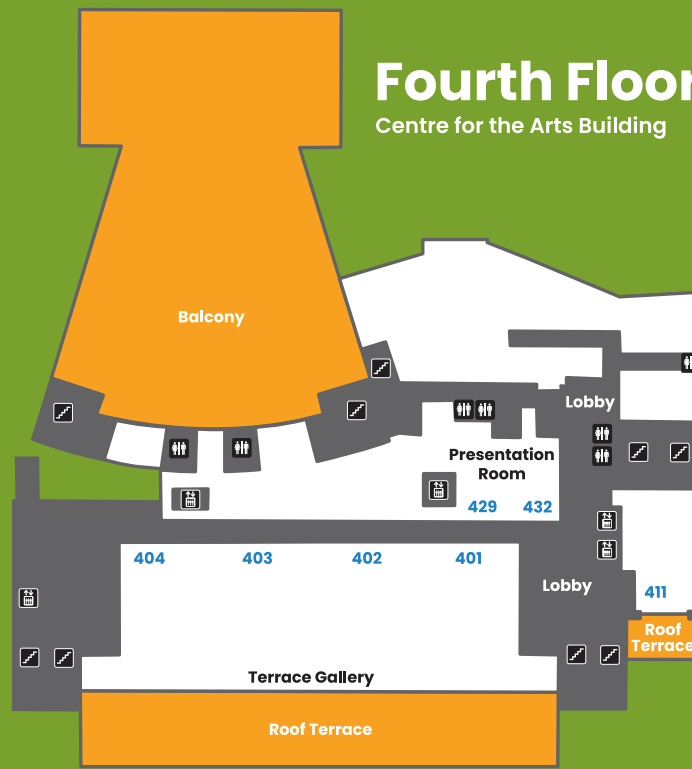

First Floor

Centre for the Arts Building

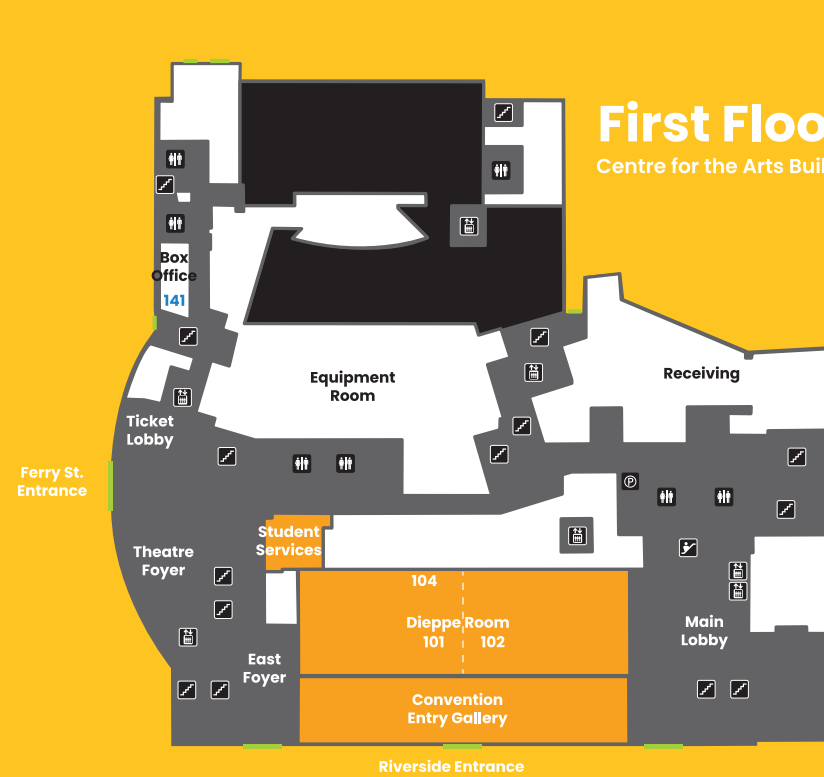

Second Floor

Centre for the Arts Building



Basement

Centre for the Arts Building



Legend

| | | | |
|--|--------------------------|--|---------------|
| | Medical Centre | | Entrance/Exit |
| | Bathrooms | | Stairs |
| | Food Service | | Elevator |
| | Parking/Security Counter | | Study Areas |

Downtown Campus

Directory

MediaPlex First Floor

| | |
|----------------------|---------|
| Newsroom | 126 |
| Radio Studio | 128 |
| Radio Control | 129 |
| TV Control Room | 124 |
| TV/Radio Server Room | 125 |
| Classrooms | 111-112 |
| Faculty Offices | 109-110 |
| Lab Classroom | 119 |

MediaPlex Basement

| | |
|-----------------|---------|
| Classrooms | 021-022 |
| Lab Classrooms | 011-012 |
| Faculty Offices | 003,006 |

Zekelman School of Business

| | |
|-------------------------|-------|
| Classrooms | 03-10 |
| Student Lounge | 18 |
| Tutoring & Testing Area | 16 |
| Board Room | 28 |
| Business Hub | 33 |
| Offices | 29-32 |

Legend

| | | | |
|--|--------------------------|--|---------------|
| | Medical Centre | | Entrance/Exit |
| | Bathrooms | | Stairs |
| | Food Service | | Elevator |
| | Parking/Security Counter | | Study Areas |

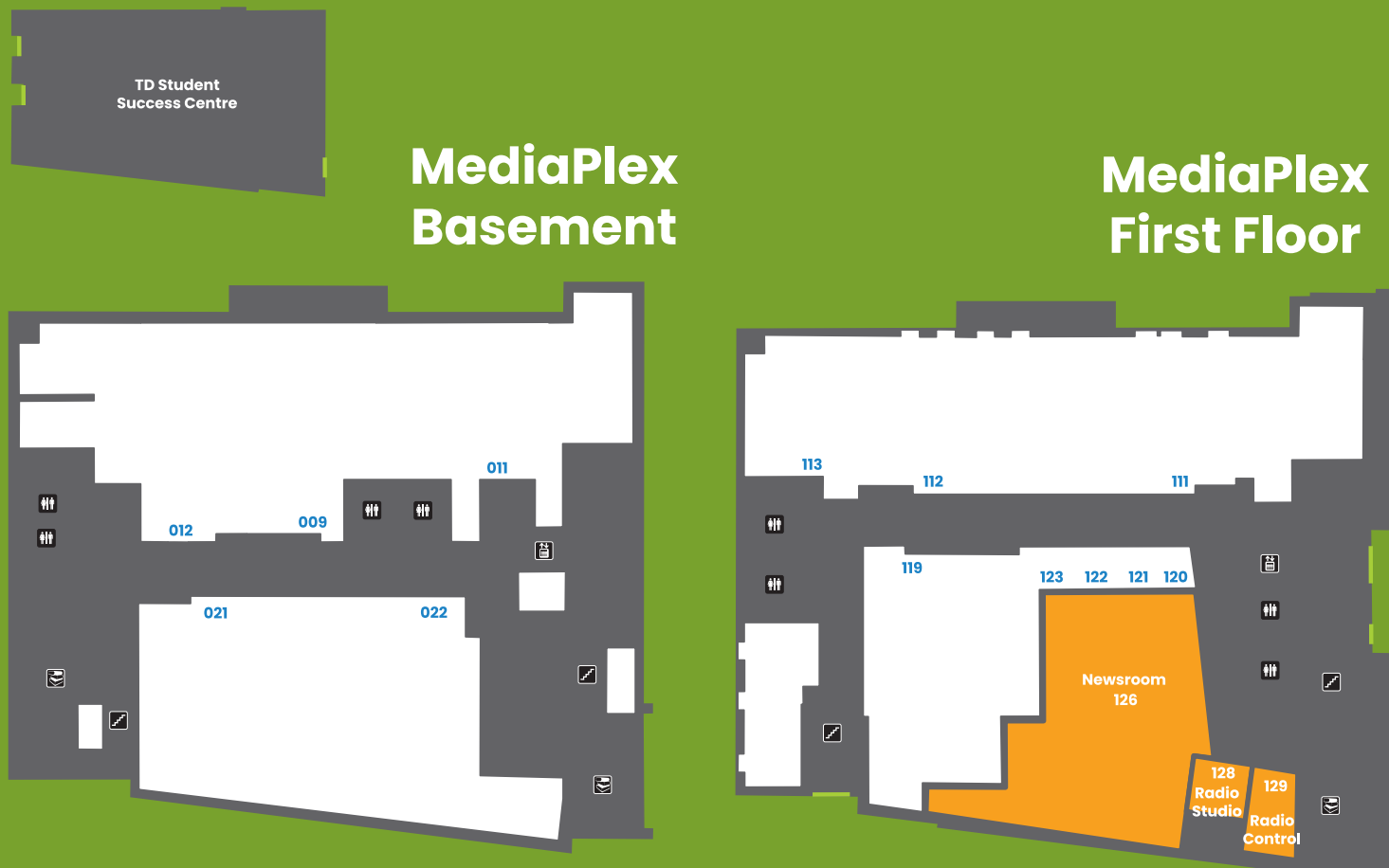

Map of Surrounding Area